



MULTI12 USER MANUAL

**12" TWO-WAY FULL RANGE
ACTIVE SPEAKER / WEDGE MONITOR**



This manual is subject to change without further notice. No rights can be derived from this manual.

AED Audio® is a registered trademark of AED Distribution NV.

©2022 - AED Audio® - www.AEDaudio.com – info@aedaudio.com



INSPIRED BY PROFESSIONALS ■ CREATED BY EXPERIENCE ■ UNMATCHED BY PERFORMANCE

TABLE OF CONTENTS

Introduction	2
Disclaimers	2
Intended use	2
General safety information and instructions	3
Warnings	3
Safety features & devices of the product	3
Modification	3
System components	4
General characteristics and technical specifications	4
Technical data	4
Dimensions drawing	4
Connectivity	5
Panel identifiers	5
Connection layout	6
Transportation, handling and commissioning	7
Transportation	7
Remove the shipping assembly	7
Installation	7
Attention	7
Maintenance	8
Troubleshooting and repair	8
Fault list	8
Repair	8
Contact details certified repair center	8
Notes	9

INTRODUCTION

The MULTI12 is a multipurpose 12" two-way self-powered speaker with built-in DSP. The cabinet is made of robust engineering Polymers which results in a lower weight, and a high power. The MULTI12 has an improved sound quality due to its high quality European branded speaker components. You can use the MULTI12 as live PA speaker, for DJ sets, with or without sub, but also as a wedge monitor, DJ monitor and for sound reinforcement in pub's, clubs, small theaters, churches and many more. This highly versatile product can be used in many ways.

With a 12" low-frequency woofer and a 1" high-frequency compression driver with a titanium diaphragm, the MULTI12 is a 2-way full-range active speaker that can be deployed in multiple applications. Its characteristics include big dynamic, high sensitivity, clear MF and HF with a powerful LF.

The MULTI12 design takes care of combining the horn with the cabinet. Due to its rigging points and mounting holes, the rigging possibilities are endless. Pair your Bluetooth device by only pressing a button and play your favourite music in an instant. Connect your instrument or microphone by using a jack or XLR input on the back panel of the speaker. The 2-way XLR/TRS input mode ensures ease of use.

With the all-weather tote that also can be used as rain cover, no weather condition is too rough to fulfil the job that has to be done. The MULTI12 is an all-round 12 inch loudspeaker that stands its ground and will make sure you will get your job done.

DISCLAIMERS

AED Audio, AED DISTRIBUTION SA, with registered office at Bedrijvenpark De Veert 13/4, 2830 Willebroek (Belgium), or any of its affiliates, does not accept any liability for material damage, including damage to the Product, or personal injury caused by non-observance by the user of the safety instructions in the Manual or the applicable laws. As such AED Audio shall among others not be liable for any damage or injury if the Product is used contrary to or for purposes other than its intended use, is installed, used, maintained or repaired negligently or contrary to the instructions mentioned in the Manual or on the Product, when the Product is modified and when the safety devices and features of the Product are disregarded or overridden.

INTENDED USE

This system is intended for use by trained personnel for professional applications. The Product is not intended to be used by minors. Any use, regardless whether or not under the supervision of an adult, is at own risk.

GENERAL SAFETY INFORMATION AND INSTRUCTIONS

For your own safety, please read this instruction manual carefully before turning on the product for the first time.

For your own safety, please read the safety instructions included with the product.

WARNINGS

Always take note of any information marked with the CAUTION or WARNING symbol.



CAUTION: The signal word WARNING points out the potential risk of serious injury.



WARNING: The signal word CAUTION points out the potential risk of slight injury. The CAUTION symbol is used to draw attention to circumstances which could cause the machine to become damaged.

SAFETY FEATURES & DEVICES OF THE PRODUCT

The pictograms, warnings and instructions attached to the Product are part of its safety features. They must not be covered or removed and must be present and legible during the entire use of the Product. Immediately replace or repair missing, damaged or illegible pictograms, warnings and instructions.



The device can only run with 240V voltage, 50/60 Hz power, don't connect to any other wrong power source.



Safety I class device, need to be earth connected.



Keep this device away from children and unauthorized users, the manufacturer will not take responsibility for the damage due to any disregard of the information provided in this manual and wrong operation.



Don't put or install the device on a surface that subject to vibration or bumps.

MODIFICATION

Under no circumstances any modification of the Product may be done by any person other than AED Audio personnel.

SYSTEM COMPONENTS

GENERAL CHARACTERISTICS AND TECHNICAL SPECIFICATIONS

TECHNICAL DATA

Frequency response (-3dB)	47 Hz to 18 kHz
Max SPL @1m	117 dB / 123 dB peak
HF Dispersion	90° x 60°
Compression driver	1x 1" HF
Woofer	1x 12" LF
Input signal	100 Hz HP with sub, Mixer in/out, Stereo/Mono, 3.5mm AUX in, Bluetooth streaming
Input connectors	2x XLR, 2x 1/4", 1/8"; Bluetooth and Main in (XLR)
Total power	500W program - 1.000W peak
Power connector	TrueCon
Cooling	Speed controlled fan
Voltage range	110V/230V AC, 50Hz/60Hz
Cabinet/Case material	Polypropylene cabinet, ABS baffle, metal grille
Handles	2x Plastic handles (1x side + 1x back)
Grille	Powder coated steel with grille cloth
Color	Black
Dimensions (HxWxD)	595 x 345 x 365 mm - 23.4 x 13.6 x 14.4 in
Package dimensions (HxWxD)	655 x 436 x 420 mm - 25.8 x 17.2 x 16.5 in
Net weight	15,6 kg - 34.4 lb
Gross weight	17,6 kg - 38.8 lb
3 performance modes	Concert - Club - Monitor
Certification	CE – UKCA – cETL

DIMENSIONS DRAWING

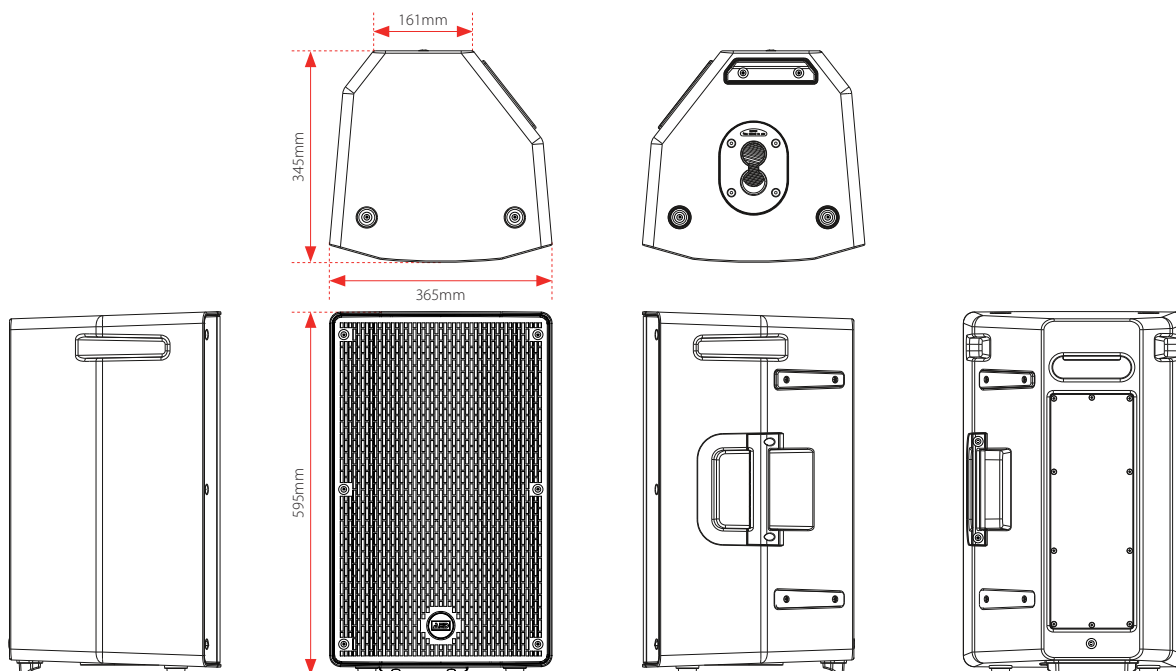

CONNECTIVITY

PANEL IDENTIFIERS



1	Gain adjust	10	Stereo / Mono switcher
2	Master volume	11	Mode selector (concert / club / monitor)
3	Line / Instrument input - Mono 1/4 TRS - $\sqrt{90\text{Hz}}$	12	Sub / No sub - $\sqrt{100\text{Hz}}$
4	Line / Instrument input - Mono 1/4 TRS	13	Mixer enable
5	Stereo / Aux In - Stereo 3.5mm	14	Link Thru - Mono XLR
6	Main In - Mono XLR	15	Scan QR code for more information
7	Mic In - Mono XLR - $\sqrt{90\text{Hz}}$	16	AC Input PowerCon
8	Mic In - Mono XLR	17	Power switch
9	Bluetooth® pairing		

CONNECTION CHART

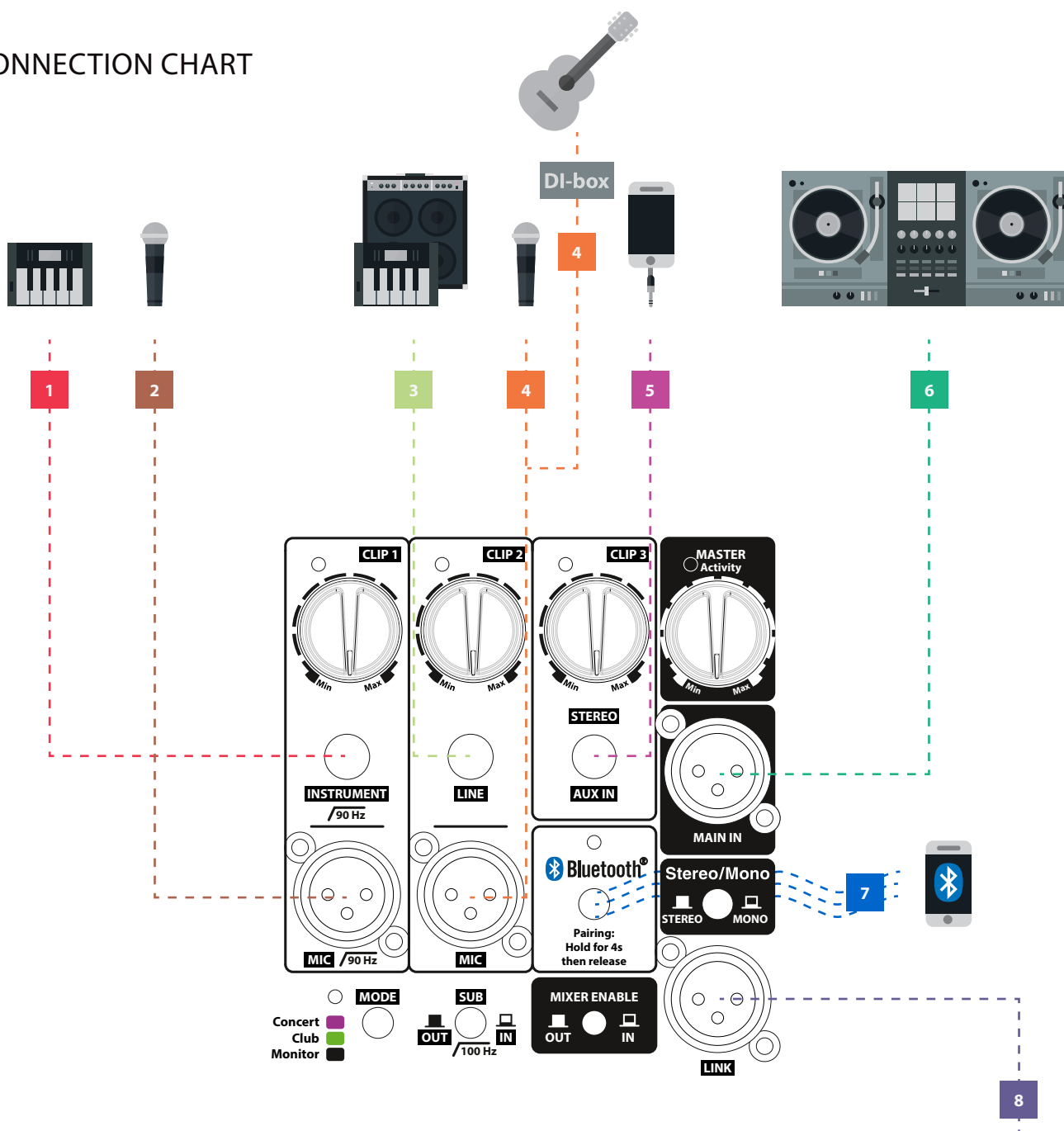

1	Keyboard or other instrument input (Line level)	Mono TRS
2	Microphone input	XLR
3	Keyboard / guitar amplifier or other instrument input (Line level)	Mono TRS
4	Microphone or instrument via DI-box) input	XLR
5	Smartphone or other device auxiliary input	Stereo 3.5 mm
6	Main input	XLR
7	Wireless connection	Bluetooth®
8	Balanced mono output	XLR



TRANSPORTATION, HANDLING AND COMMISSIONING

TRANSPORTATION

Keep the product dry and the temperature between 0°C and 30°C to avoid damage to the speaker. Please always handle with care.

REMOVE THE SHIPPING ASSEMBLY

Before unpacking the fixture, please make sure that the packaging is in good condition and that following items will be found in the box:

- 1x MULTI12
- 1x Safety instructions

Remove the tape from the box and open the box. Take the unit out and remove the plastic foil around the unit. Make a visual inspection of the unit. Please check condition of units while unpacking, if any damages occur, the unit must be repaired/replaced before it can be used. Please contact your local distributor for service. If units are damaged and still used, AED Audio cannot be held liable for any risk/danger or occurrence given by these damaged units.

INSTALLATION

There are specific regulations like BGV C1 (old VBG 70) or country related regulations which need to attend during the installation. The installation has to be handled by skilled persons only!

Suspension device has to be built and calculated in order to handle up to 10 times its specific load limit over a time of one hour without permanent or harmful deformation.

Installation has to be done with a separate, independent suspension device like a safety chain.

Trespassing the danger zone below the installation during the assembling is prohibited.

Installer has to take care of all safety and machinery installations are approved by authorized persons before first operation or after changes before restarting.

Installer has to take care of all safety and machinery installations are approved by skilled persons at least once a year.

Installer has to take care of all safety and machinery installations are approved by authorized persons every four years during the acceptance inspection. Spotlight should ideally installed outside peoples lounge area.

ATTENTION

Installation overhead needs a high level of experience. This includes (but is not just limited to) calculation and definition of load capacity, used installation material and regular safety inspections of used material and the fixture itself.

Never try to do the installation by yourself if you are not qualified, instead you have to instruct a skilled installer.

Inappropriate installations can cause injuries and/or damage of property.



CAUTION: Mounting place must be sufficient stable and be able to support a weight of 10 times of the unit's weight.



CAUTION: Assure the specified safety distances to flammable material.

MAINTENANCE

Operation only allowed to qualified person, damages due to unprofessional operation or remove of any parts inside will not be considered in warranty service. There are no serviceable parts inside the device or package, service only leaves to authorized dealers.

TROUBLESHOOTING AND REPAIR

FAULT LIST

PROBLEM	SOLUTION
Bluetooth® doesn't connect	Check if your telephone Bluetooth® function is active
The unit will not turn on	Try a different power socket or check the power on switch (more info: on page 5). If this doesn't work, contact your repair center.
There is no bass in my music	Check button number 12 (Sub / No Sub) (more info: page 5)
The unit sounds distorted	Check the gain adjust settings (more info: page 5)
My microphone is connected but I have no sound	Check the Mixer enable button (more info: page 5)
I have connected with Bluetooth® but I don't hear anything	Check if your music on your mobile device is playing

REPAIR

If the Product is damaged or malfunctions, contact the AED Audio Service Department or a AED Audio authorized distributor. Repairs by parties other than AED Audio or a AED Audio authorized distributor may not involve the use of AED Audio genuine parts and may affect the safety and functionality of the Product. For repair options or specific inquiries, please contact the AED Audio Service Department.

CONTACT DETAILS CERTIFIED REPAIR CENTER

AED Repair

Bedrijvenpark De Veert 11, 2830 Willebroek – Belgium

info.repair@aedgroup.com

aedgroup.com/en/services/aed-repair

NOTES

All rights reserved. No part of this manual may be copied or published by means of printing, photocopying, microfilm or otherwise without the prior written consent of the manufacturer. This restriction also applies to the corresponding drawings.

The information given in this manual has been collected for the general convenience of our customers. It has been based on general data pertaining to construction material properties and working methods known to us at the time of issue of the manual and is therefore subject at any time to change or amendment, and the right to change or amend is hereby expressly reserved. The instructions in this manual only serve as a guideline for installation, use, maintenance and repair of the product mentioned on the cover page of this document. This manual is to be used for the standard model of the product of the type given on the cover page. Thus the manufacturer cannot be held responsible for any damage resulting from the application of this manual to any other product.

This manual has been written with great care. However, the manufacturer cannot be held responsible, either for any errors occurring in this manual or their consequences.



WWW.AEDAUDIO.COM



AEDaudio



aed_audio